

High Performance Smart Positioner engineered for reliability, ease of use and long service life, even under harsh working environments

Moniteur's Series 71 Smart Positioner has been designed to excel in the harsh working conditions found in the toughest environments. Compared with other smart positioners, the Series 71 is easier to calibrate and program, is more resistant to dirty air and vibration, and has the lowest cost of ownership.

The Series 71 has a wide range of communication options including HART, Profibus and Foundation Fieldbus. It also carries ATEX and IECEx certification for Intrinsically Safe and Flameproof. For severely corrosive environments a stainless steel enclosure is available. Check out the long list of features:



Features

- ▶ Easy and quick auto-calibration
- ▶ Detecting RA (reverse acting) or DA (direct acting) automatically regardless of wrong air connections
- ▶ Available for single or double acting without any special adjustments
- ▶ Compact design allowing to be installed on small actuators
- ▶ Providing error messages against performance failures
- ▶ Possible to test the actuator with any fixed signal under a test mode
- ▶ Programmable characteristic curve with 17 points
- ▶ Wide operating temperature range -30 ~ +80 °C
- ▶ Improved control of high-friction globe and ball valves by eliminating overshoot and hunting
- ▶ Low air consumption
- ▶ Providing a mounting bracket to meet IEC 60534-6-1 for linear valves
- ▶ Supporting a NAMUR mounting pattern VDI/VDE 3845 (IEC 60534-6-2) and providing a multi-size mounting bracket for rotary valves

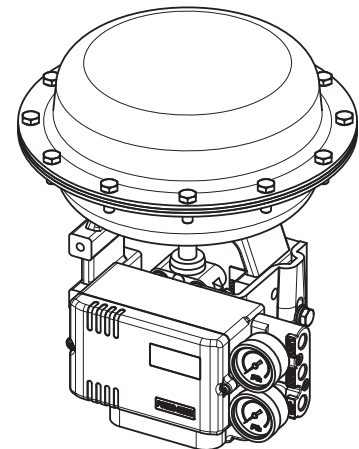

Linear Type

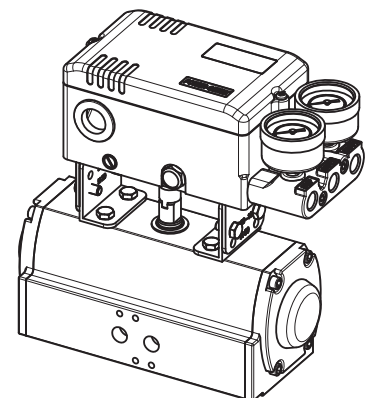

Rotary Type

Options

- ▶ Output position transmitter (4 - 20 mA)
- ▶ 2 x alarm limit or micro switch (SPDT)
- ▶ Explosion proof type (IECEx / ATEX / KC Ex ia IIC T5)
- ▶ HART communication
- ▶ Profibus communication
- ▶ Fieldbus Foundation communication

Specifications

Input Signal	4 - 20 mA @ 24 VDC
Min. / Max. Current	3.6 mA / 50 mA
Voltage Drop (Resistance)	Without Hart : 8.7 VDC (435Ω @ 20 mA) With Hart : 9.4 VDC (470Ω @ 20 mA)
Stroke / Angle	Linear type : 5 - 130 mm * Rotary type : 25 - 120°
Air Supply Pressure	1.4 - 7.0 bar (20 - 100 psi), filtered, compressed dry and non-oiled to meet Class 3 of ISO 8573-1
Output Pressure Range	0 - 100% of supply air pressure
Air Capacity	80 l/min = 4.8 N ^m /h = 2.8 scfm (Sup = 1.4 bar) 233 l/min = 14 N ^m /h = 8.2 scfm (Sup = 6 bar)
Air Consumption	2 l/min = 0.12 N ^m /h = 0.07 scfm (Sup = 1.4 ~ 6 bar)
Characteristic	Linearity < ±0.3% F.S Sensitivity < 0.2% F.S Hysteresis < 0.2% F.S Repeatability < 0.2% F.S
Performance Characteristic	Linear, EQ %, Quick open, User set (17 points)
LCD Indication	4-digit LCD indicator
Adjustable Speed	1 - 1000 (lowest 1, highest 1000)
Scan Time	2ms
Shut-off Value	Range 0 - 10% of position signal
Valve Action	direct action (DA) / reverse action (RA)
Operating Temperature	- 30 ~ +80°C (- 22 ~ +176 °F) **
Pneumatic Connections	PT(Rc) 1/4 or NPT 1/4
Electrical Connections	2 x PF(G) 1/2 or NPT 1/2
Protection Class	IP66, intrinsically safe (IECEX / ATEX / KC Exia IIC T5)
Body Material	Aluminum die-cast / powder-painted
Weight	1.6 kg

* Up to 200mm on request ** -40°C on request

Principle of Operation

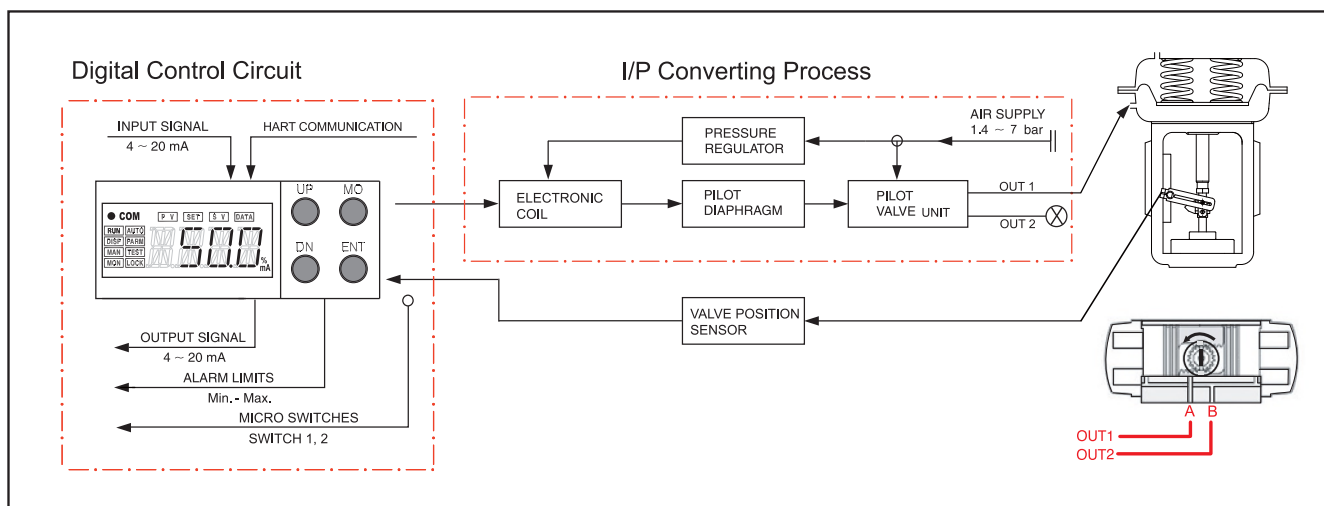

If 4-20 mA input signal is supplied, the micro processor compares input signal with position feedback and sends control signal to the I/P converting module. Pneumatic signal from the I/P converting module operates the valve and the valve stays at the desired position.

Mounting to Rotary Actuator

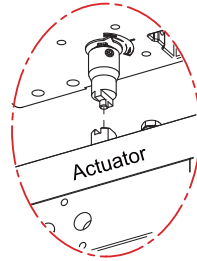
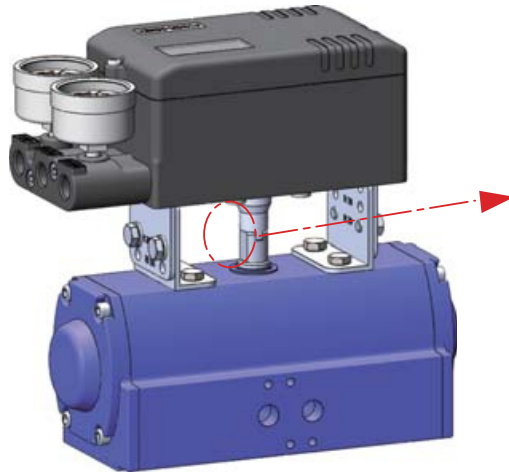

NAMUR Type Mounting
(VDI/VDE 3845,
IEC 60534-6-2)

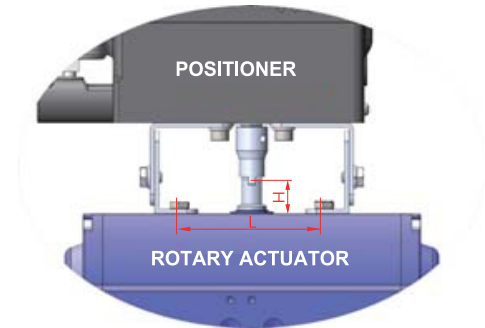

Size Variation of Multi-Size Bracket

- 1) 80 x 30 x 20 (H) , 4) 130 x 30 x 20 (H)
- 2) 80 x 30 x 30 (H) , 5) 130 x 30 x 30 (H)
- 3) 80 x 30 x 50 (H) , 6) 130 x 30 x 50 (H)

H : Rotary Actuator Shaft Height
L : Length (80 or 130mm)

How to Order

71

Actuator
Operation

Protection
Class

Communi
cation

Position
Feedback

Options

Description	Code	
Housing Material	71	Cast Aluminum
	71S	Cast Stainless Steel
Actuator Operation	E	Rotary NAMUR
	L1	Linear 5-30mm
	L2	Linear 5-65mm
	L3	Linear 5-130mm
Protection Class	L4	Linear 80-200mm
	W	Weatherproof IP66
	I	Intrinsically Safe
	F	Flameproof

Description	Code	
Communication :	4	4-20 mA
	H	HART
	P	Profibus PA
	F	Foundation Fieldbus
Position Feedback :	N	None
	O	4-20 Output
	S	2 x SPDT Switches
	Q	4-20 Output + Switches
Mounting Bracket :	Stainless Steel IEC 60534-6-1 for Linear IEC 60534-6-2 for Rotary	

Linear Type

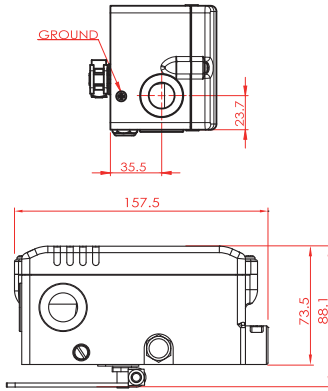

< Without Gauge Block >

Dimensions

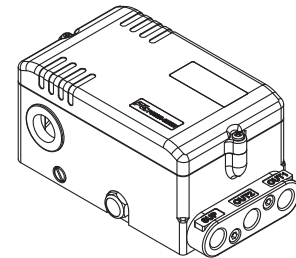
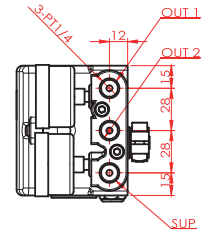
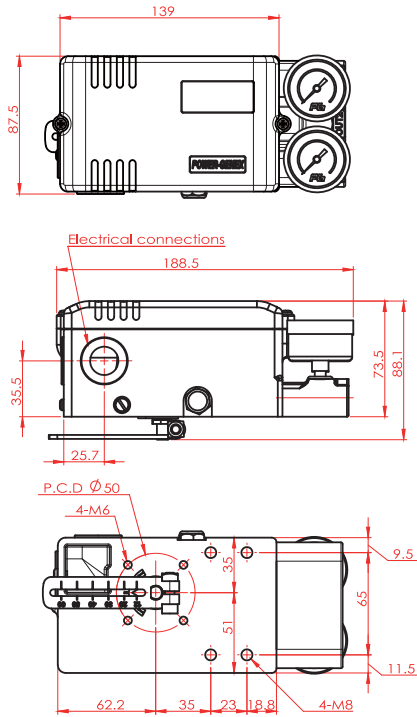

Without Gauge Block

Rotary Type

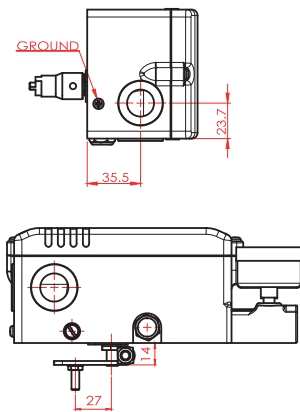

< Fork Lever Type >

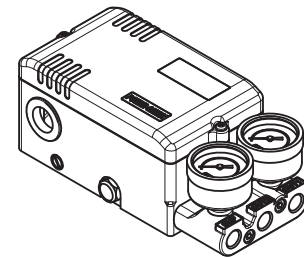
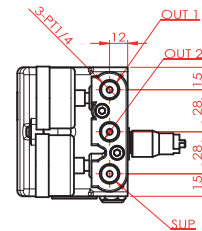
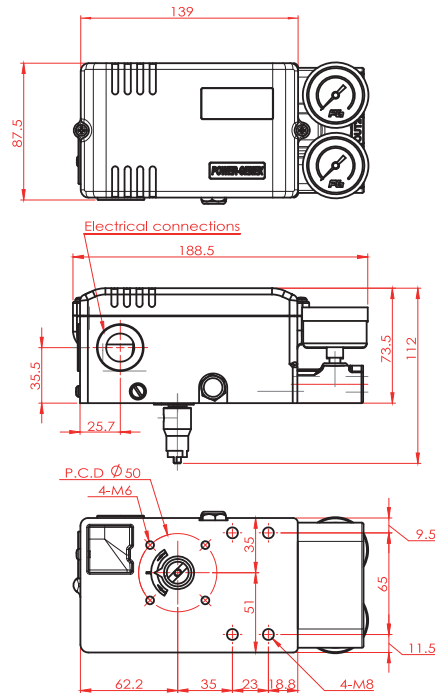

With Gauge Block

2 x SPDT Micro S/W

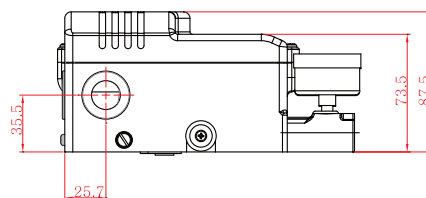
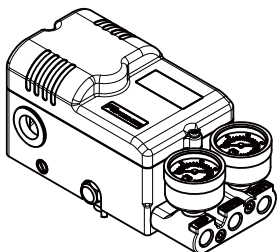

Distributed by | Distribuido por :



ANYTHING
≈ FLOWS ≈

INFO@ANYTHINGFLOWS.COM

WWW.ANYTHINGFLOWS.COM

Flow Control , our passion ®

Life Flows on ™



SCAN ME