

PRECISION Instrument Manifolds

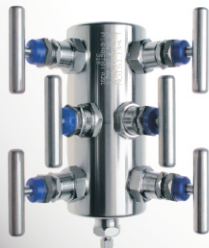
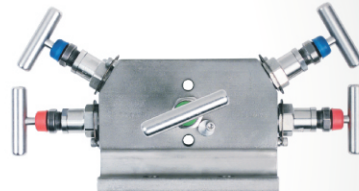
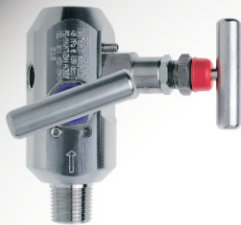

PRECISION Instrument Manifold & Valves
“The New Standard”

PRECISION Instrument Manifolds

Direct Mount Manifolds

PRECISION's line of transmitter manifolds are designed to mate directly to all transmitters. Additionally, a complete line of remote mount manifolds is on offer to the highest national and international standards and speciality manifolds are made to order on client request. PRECISION Manifolds feature industry standard sized Teflon or Graphoil 'O'-Rings with seal grooves being precisely machined so that 'O'-Ring does NOT fall out during normal handling.

TRANSMITTER
MANIFOLDS

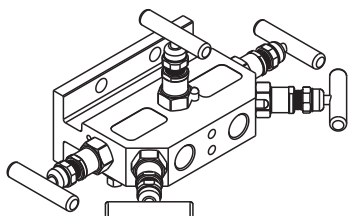

T Section Valves

Process Inlet	:	Screwed as per requirement
Instrument Connection	:	Standard DIN 19213 'O' Rings
Available	:	2, 3 & 5 Valve
Rating	:	6000 PSI
Qualification	:	ASME B31.1 & B31.3 to ASME VIII
Rating	:	10000 PSI
Qualification	:	MSS-SP-99 to ASME VIII

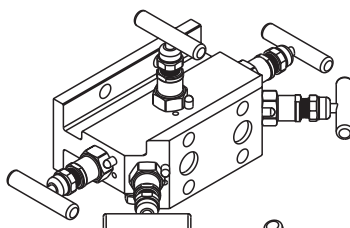

H Section Valves

Process Inlet	:	Flat to Std DIN 19213 IEC61518
Instrument Connection	:	Standard DIN 19213 'O' Rings
Available	:	2, 3 & 5 Valve
Rating	:	6000 PSI
Qualification	:	ASME B31.1 & B31.3 to ASME VIII
Rating	:	10000 PSI
Qualification	:	MSS-SP-99 to ASME VIII

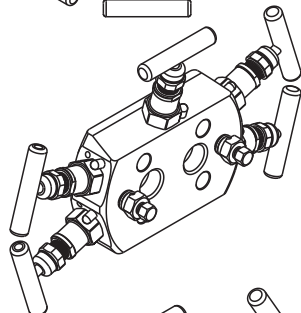

Flatpack Valves

Process Inlet	:	Screwed as per requirement
Instrument Connection	:	Standard DIN 19213 'O' Rings
Available	:	2, 3 & 5 Valve
Rating	:	6000 PSI
Qualification	:	ASME B31.1 & B31.3 to ASME VIII
Rating	:	10000 PSI
Qualification	:	MSS-SP-99 to ASME VIII

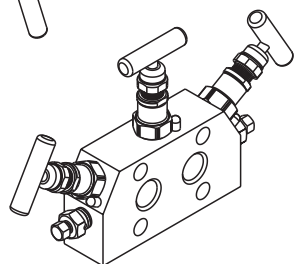

Coplanar Flatpack Valves

Process Inlet	:	Screwed as per requirement
Instrument Connection	:	Coplanar - 41.3 x 54 mm
Available	:	2, 3 & 5 Valve
Rating	:	6000 PSI
Qualification	:	ASME B31.1 & B31.3 to ASME VIII
Rating	:	10000 PSI
Qualification	:	MSS-SP-99 to ASME VIII

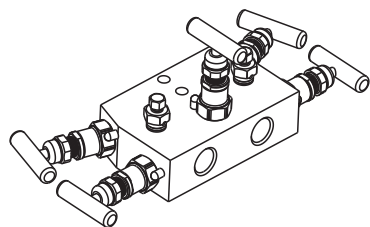

Remote Mount Valves

Process Inlet	:	Screwed in 2.13" or to order
Instrument Connection	:	Screwed in 2.13" or to order
Available	:	2, 3 & 5 Valve
Rating	:	6000 PSI
Qualification	:	ASME B31.1 & B31.3 to ASME VIII
Rating	:	10000 PSI
Qualification	:	MSS-SP-99 to ASME VIII

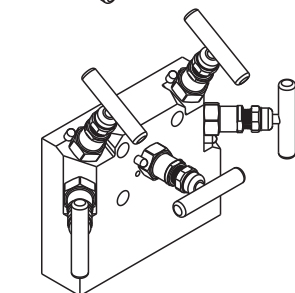

Enclosure Mounting Valves

Process Inlet	:	Screwed as per requirement
Instrument Connection	:	Standard DIN 19213 'O' Rings
Available	:	2, 3 & 5 Valve
Rating	:	6000 PSI
Qualification	:	ASME B31.1 & B31.3 to ASME VIII
Rating	:	10000 PSI
Qualification	:	MSS-SP-99 to ASME VIII

PRECISION Instrument Manifolds

Transmitter Manifolds Fully Certified Instrument Valves

GOST-R CRN ASME B31.1 ASME B31.3 ASME VIII

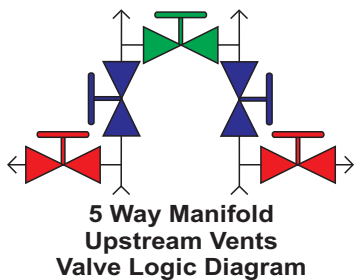
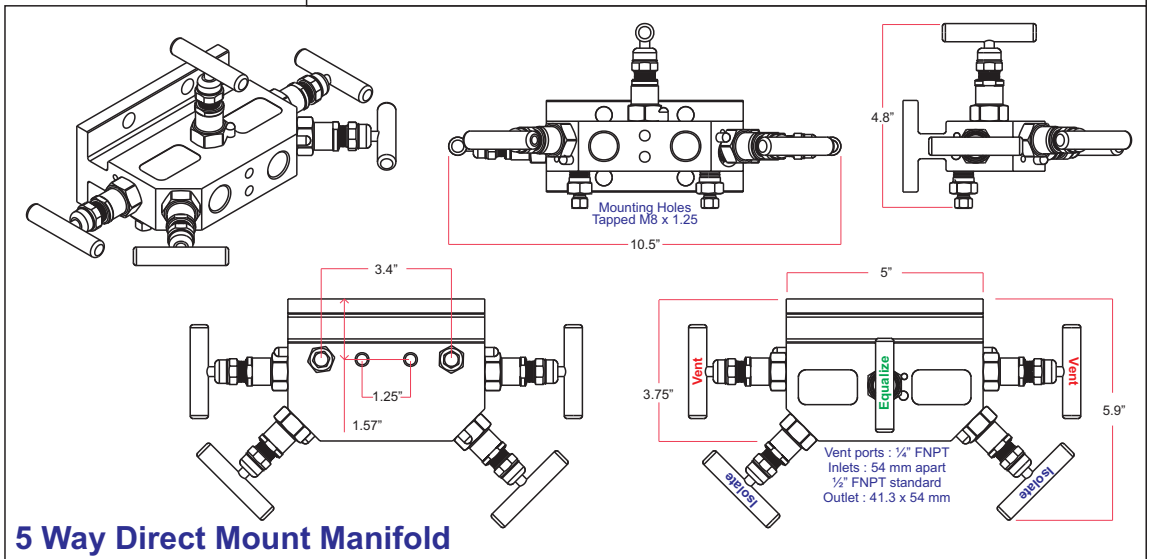
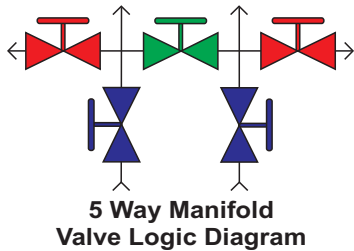
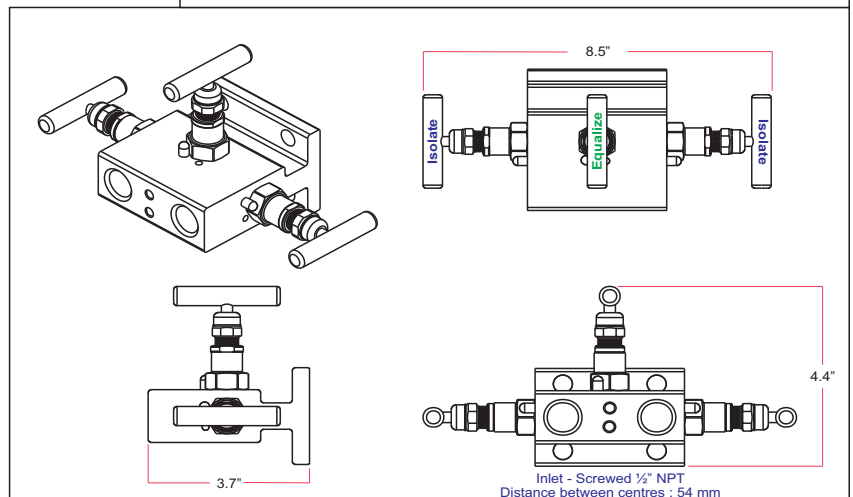
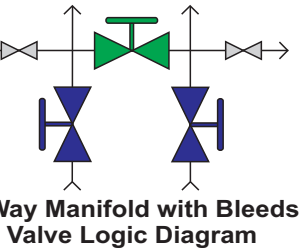
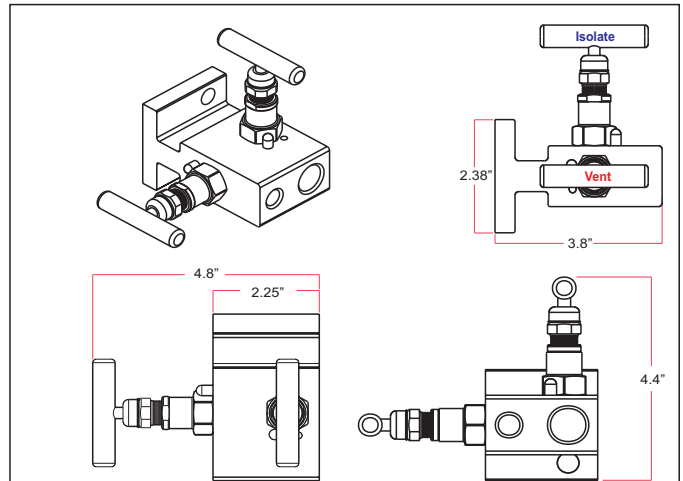
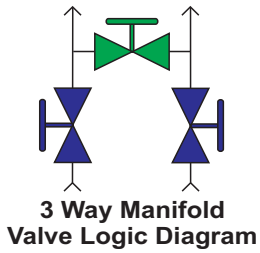
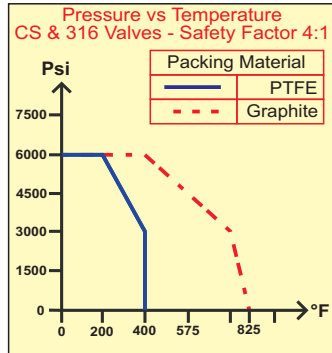
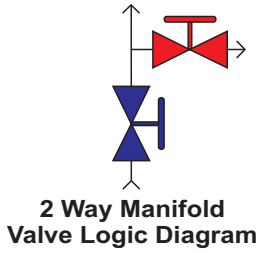

TRANSMITTER MANIFOLDS

PRECISION Instrument Manifolds

Transmitter Manifolds Fully Certified Instrument Valves

GOST-R CRN ASME B31.1 ASME B31.3 ASME VIII

TRANSMITTER
MANIFOLDS

2 Way Direct Mount Manifold

½" FNPT Kidney Flange

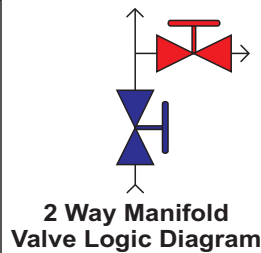

3 Way Direct Mount Manifold

3 Way Manifold Valve Logic Diagram

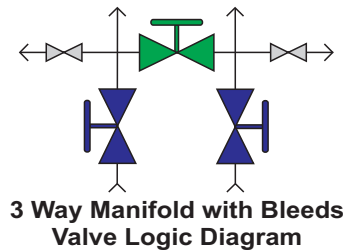
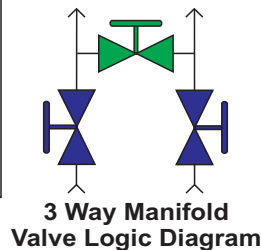

5 Way Direct Mount Manifold

5 Way Manifold Valve Logic Diagram

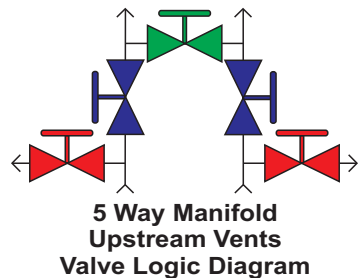
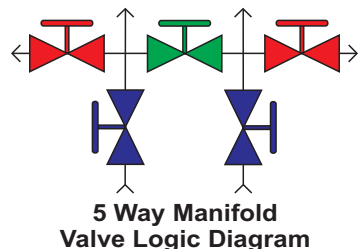

PRECISION Instrument Manifolds

Flatpack Transmitter Manifolds

TRANSMITTER MANIFOLDS

<p>S2/FTHXX</p>	<p>S3/BTHXX</p>
<p>S3/DTHXX</p>	<p>S3/FTHXX</p>
<p>S3/STHXX-Q</p>	<p>S5/FTHXX</p>
<p>S5/BTHXX</p>	<p>S5/S44THXX</p>

PRECISION Instrument Manifolds

Transmitter Manifold Selection Chart

TRANSMITTER MANIFOLDS

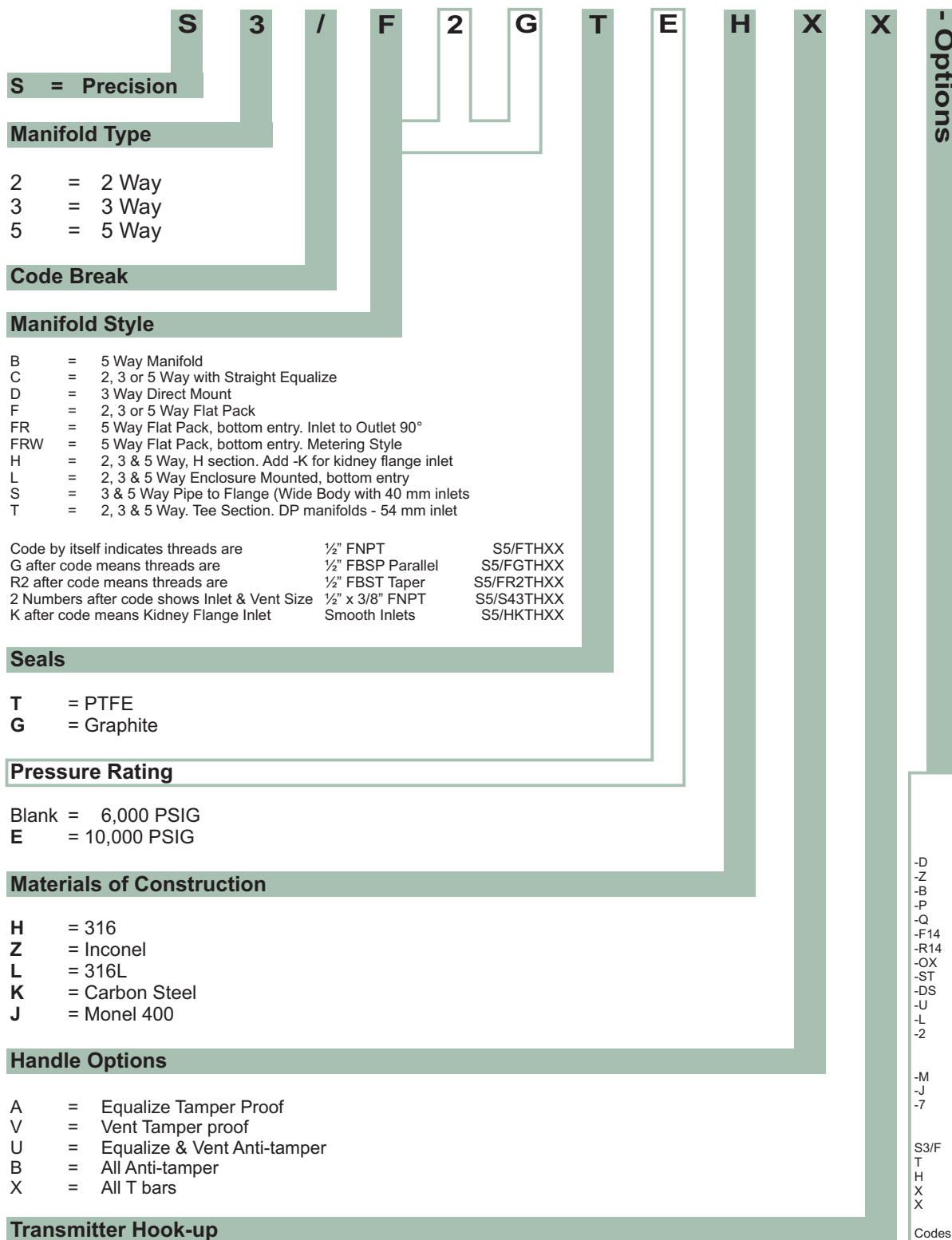

Options
Adders must be placed at the end of the Part Number

Adders

- D = Plated Tx bolts
- Z = 316 bolts
- B = Bleed Screw
- P = Plugs in Bleed or Vent Ports
- Q = Bleed Plugs in Vent Ports
- F14 = Front mounting (M8 X14)
- R14 = Bottom mounting (M8 X14)
- OX = Oxygen Service
- ST = Steam Trace Mounting Holes
- DS = Dual Stuffing Box
- U = Upstream Vents
- L = Lockable Tee Bars
- 2 = 1/2" Bleed Ports

Trim

- M = Metering Tip
- J = Monel 400
- 7 = 17/4 PH Condition H1075

Example - P3/FTHXX-D-F

- S3/F = 3 way direct mount
- T = PTFE seals throughout
- H = 316 ss
- X = Handles are T-Bars
- X = Flanged outlet - 41.3 x 54

Codes are position sensitive i.e. S3/FTHXX

Distributed by | Distribuido por :



ANYTHINGTM
≈ FLOWS ≈

INFO@ANYTHINGFLOWS.COM

WWW.ANYTHINGFLOWS.COM

Flow Control , our passion ®

Life Flows on TM



SCAN ME